

# Nebraska Legislative District 19 - LB3 - Final Reading (2021)

LEG21-39006-19

I hereby certify that this map is true and accurate as enacted by the 2021 Nebraska Legislature

*Lou Ann Linehan*  
 Senator Lou Ann Linehan  
 Chairperson, 2021 Redistricting Committee

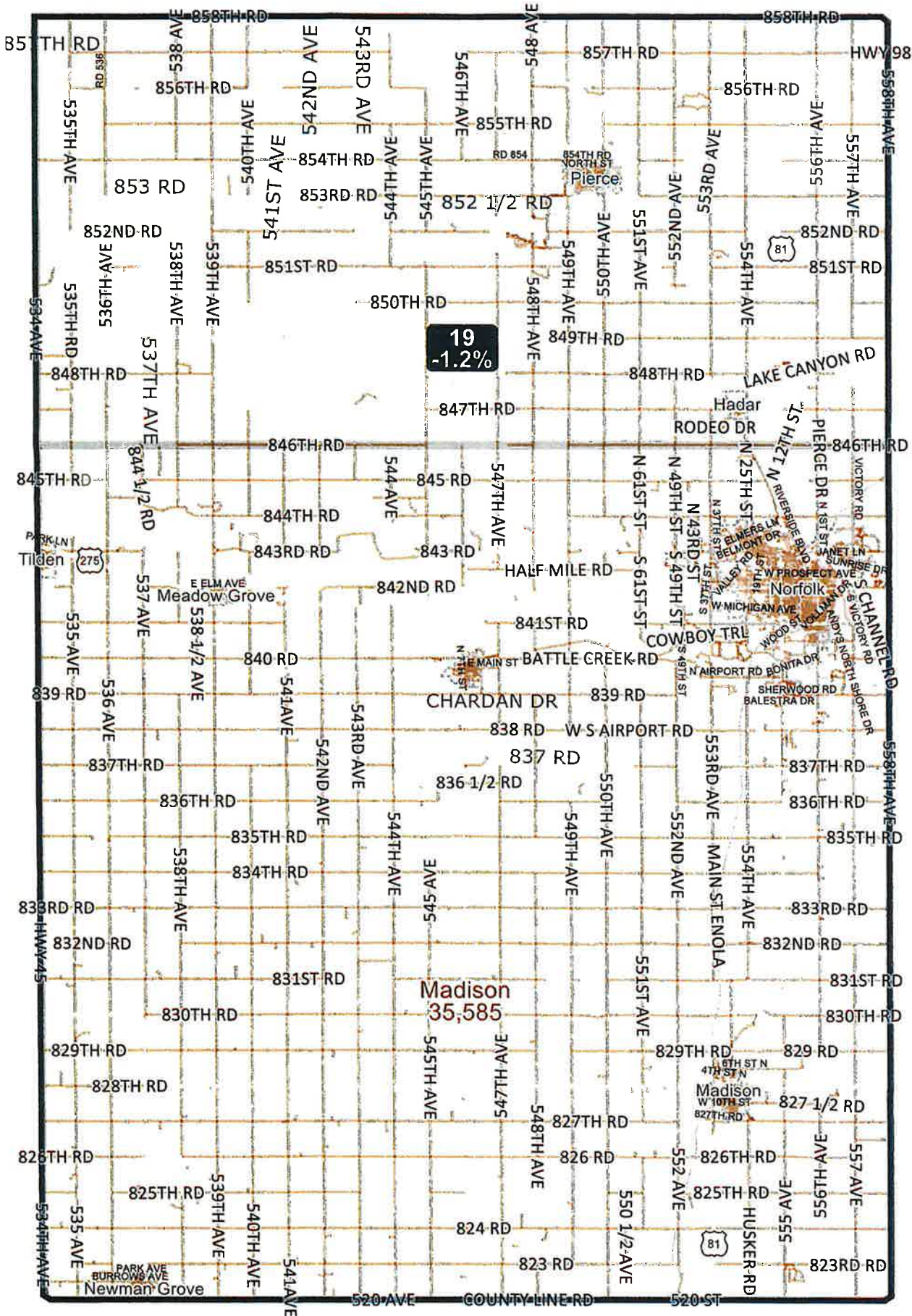

## District 19 Statistics

Field	Value
District	19
Population	39550
Deviation	-481
% Deviation	-1.2%
18+_Pop	29672
% 18+_Pop	75.02%
18+_Wht	25293
% 18+_Wht	85.24%
H18+_Pop	3467
% H18+_Pop	11.68%
18+_Blk	309
% 18+_Blk	1.04%
18+_WhtBlk	64
% 18+_WhtBlk	0.22%
18+_Ind	335
% 18+_Ind	1.13%
18+_Asn	325
% 18+_Asn	1.1%
18+_Hwn	9
% 18+_Hwn	0.03%
18+_Oth	1756
% 18+_Oth	5.92%

LEG21-39006-19  
 U.S. Bureau of the Census  
 (Population Data), 2020



Created by - Legislative Research Office  
 Source - U.S. Census Bureau  
 Date - September 29, 2021

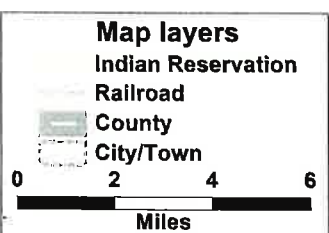

©2021 CALIPER; ©2020 HERE