

I hereby certify that this map is true and accurate as enacted by the 2021 Nebraska Legislature

Senator Lou Ann Linehan
Chairperson, 2021 Redistricting Committee

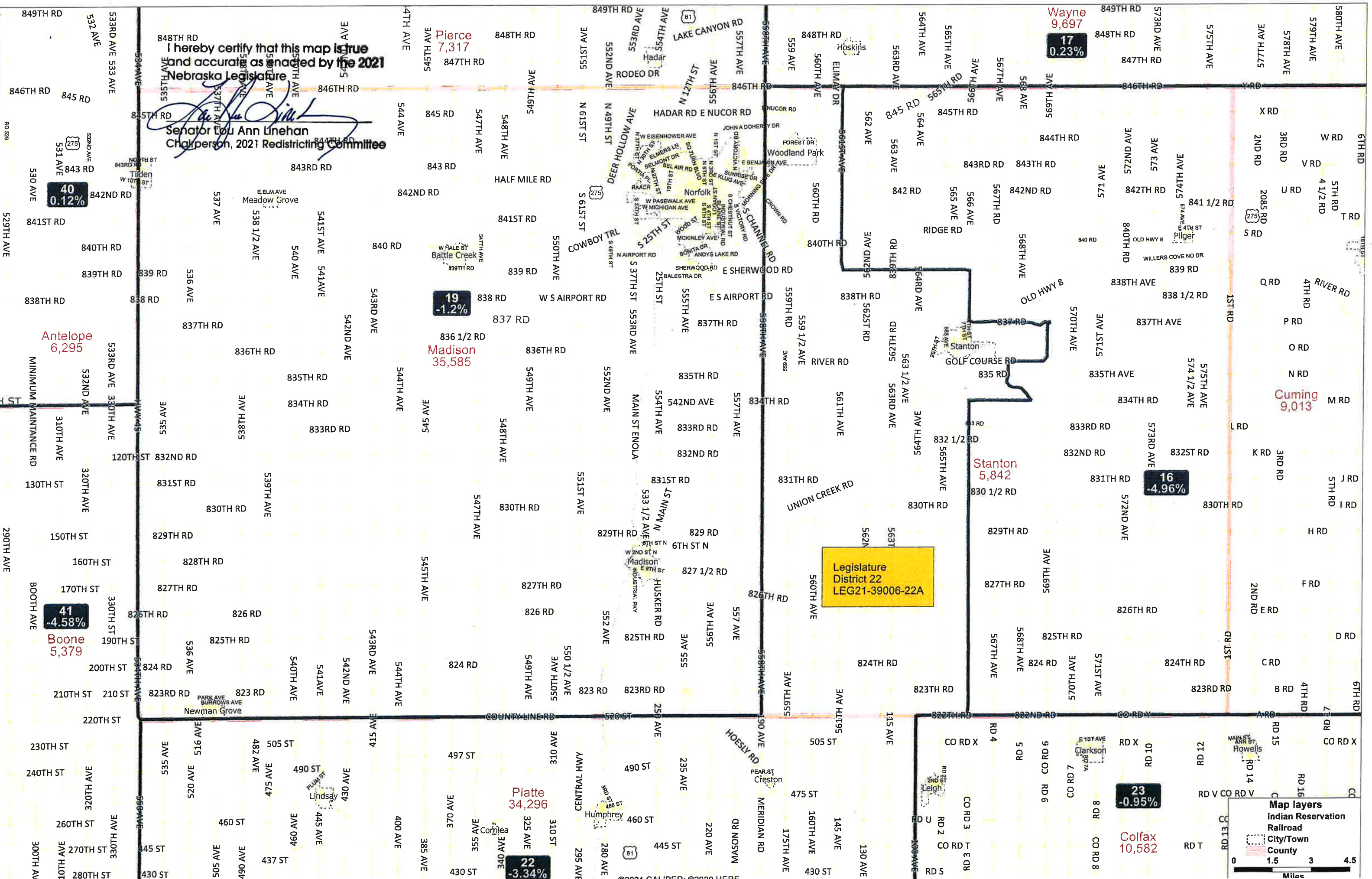

Wayne
9,697
17
0.23%

40
0.12%

19
-1.2%

Madison
35,585

16
-4.96%

Stanton
5,842

41
-4.58%

Boone
5,379

Platte
34,296

22
-3.34%

23
-0.95%

Colfax
10,582

Legislature
District 22
LEG21-39006-22A

Map layers

- Indian Reservation
- Railroad
- City/Town
- County

0 1.5 3 4.5
Miles